



PLANT PLAN: Columbarium Planting

ARLINGTON NATIONAL CEMETERY
EDUCATION SERIES



Columbarium: section for cremated remains. Walls with name markers surround small courtyards.

KEY

-  Existing shrub
-  Existing tree

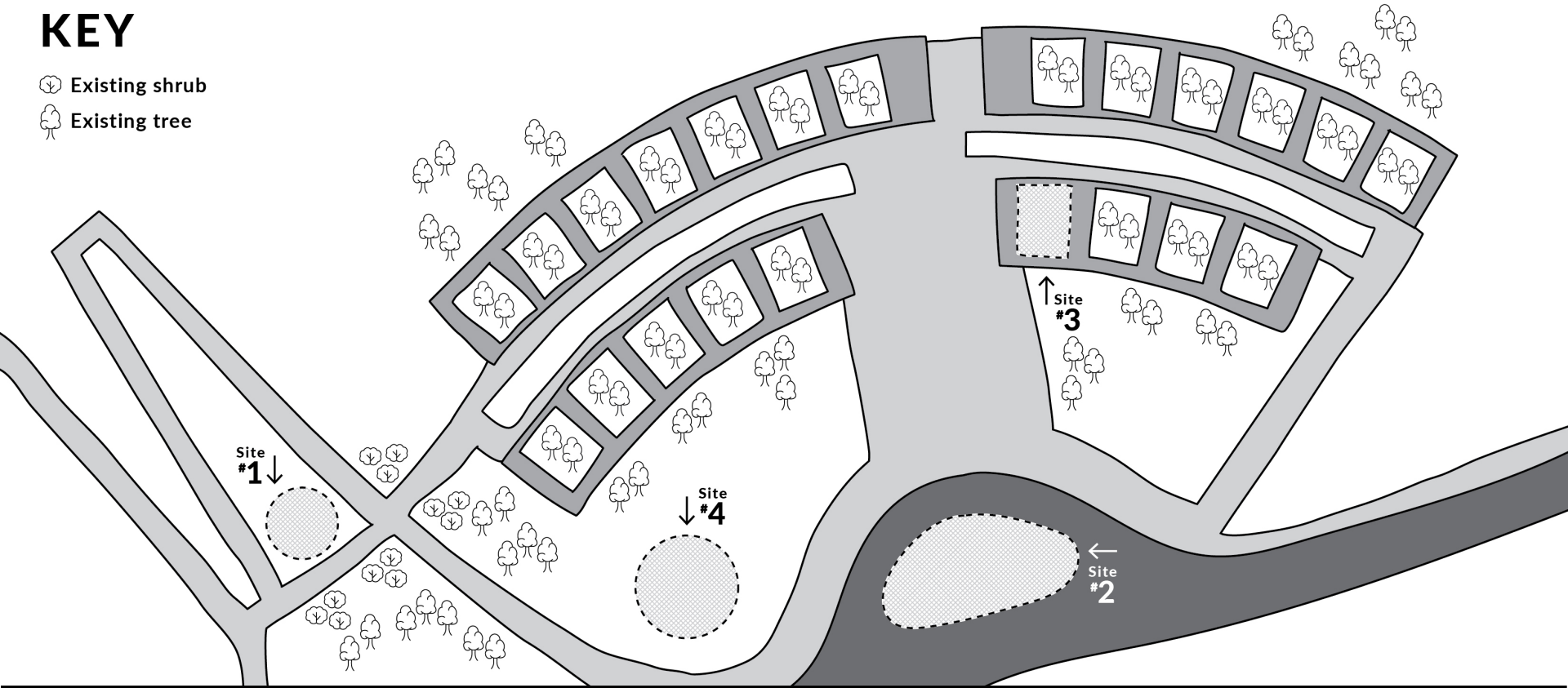

Site #1: Choose 1 shrub

- Partial shade
- Soil drains well

Site #2: Choose 1 shrub

- Very sunny
- Soil is often wet

Site #3: Choose 1 tree

- Small area surrounded by sidewalk
- Partially shady
- Soil is often wet

Site #4:

- Very sunny
- Soil drains well

WILDLIFE:

- Foxes, coyotes, small mammals, and birds live in Arlington Woods.
- Animals will visit sections near the woods if food is available.



PLANT PLAN: Section 27 Planting

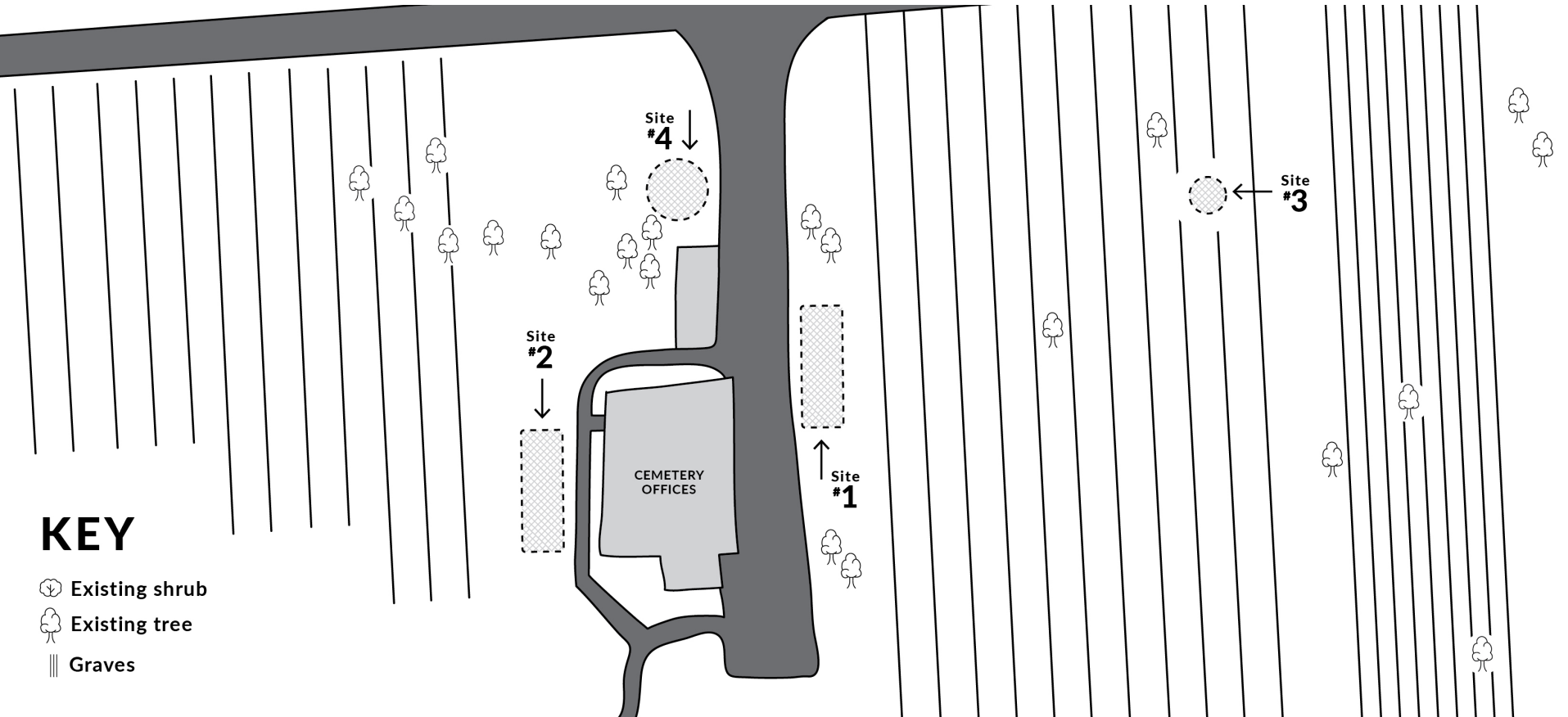

Section 27: One of the oldest sections of the cemetery with tall trees and older headstones.



KEY

-  Existing shrub
-  Existing tree
-  Graves

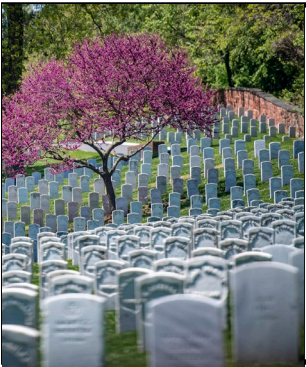

Site #1: Choose 1 shrub

- Partial shade
- Soil drains well

Site #2: Choose 1 shrub

- Mid-afternoon sun
- Soil drains well

Site #3: Choose 1 tree

- Surrounded by headstones
- Replacement for a large oak tree
- Sunny site

Site #4: Choose 1 tree

- Morning sun
- Soil drains well

WILDLIFE:

- Large trees in this section attract squirrels and a variety of birds.
- Animals will visit sections near the woods if there is food available.



PLANT PLAN: Rain Garden Planting

ARLINGTON NATIONAL CEMETERY
EDUCATION SERIES



Rain Garden: Many visitors see this section of the cemetery and the entire area receives a lot of sunshine.

KEY

-  Existing shrub
-  Existing tree
-  Graves

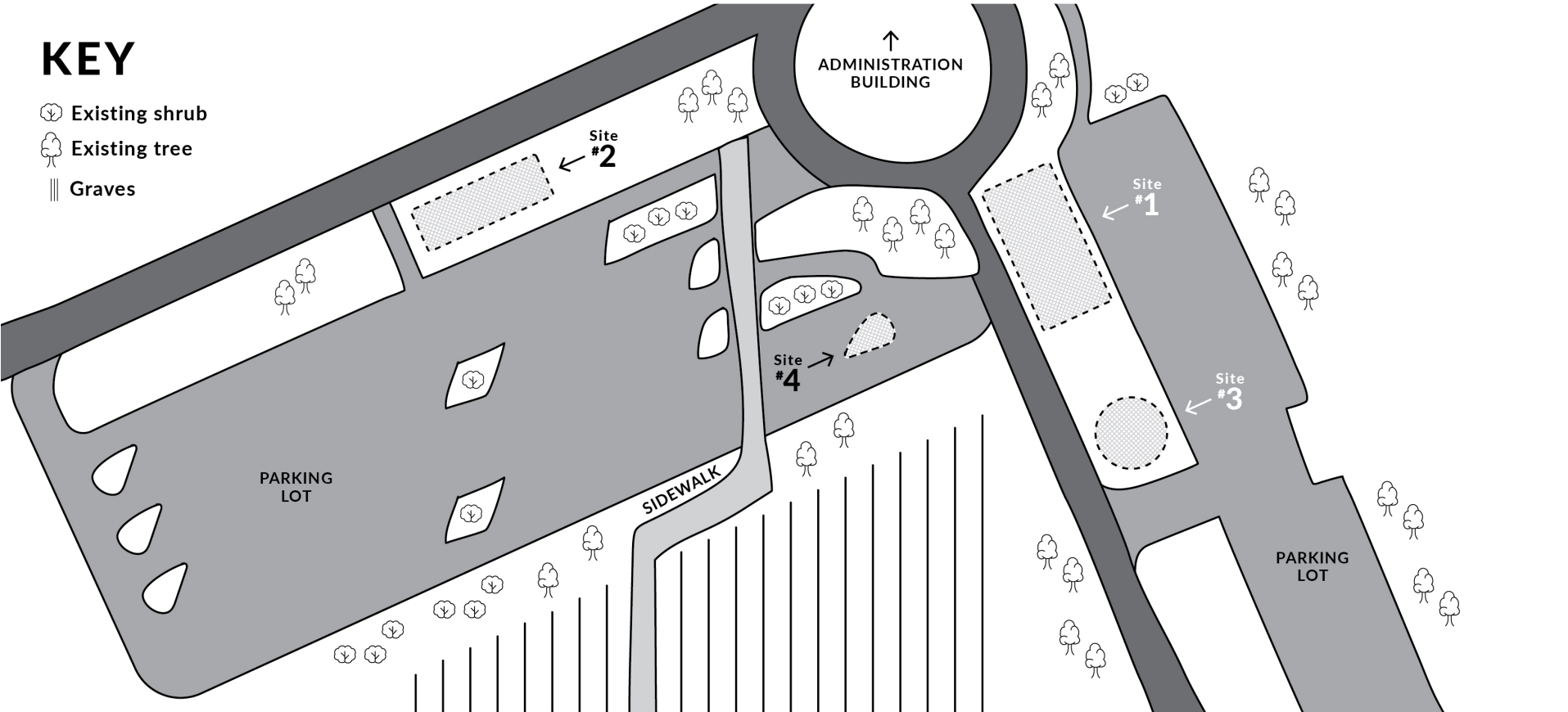

- Site #1:** Choose 1 shrub
- Partial shade
 - Soil drains well

- Site #2:** Choose 1 shrub
- Mid-afternoon sun
 - Soil drains well

- Site #3:** Choose 1 tree
- Soil is often wet
 - Sunny site

- Site #4:** Choose 1 tree
- Small area between parking lots
 - Soil drains well

WILDLIFE:

- Mostly insects and birds



PLANT PLAN: USS Maine Memorial Planting

ARLINGTON NATIONAL CEMETERY
EDUCATION SERIES



Maine Memorial: Hilly section of the cemetery around a monument that receives many visitors.

KEY

-  Existing tree
-  Graves

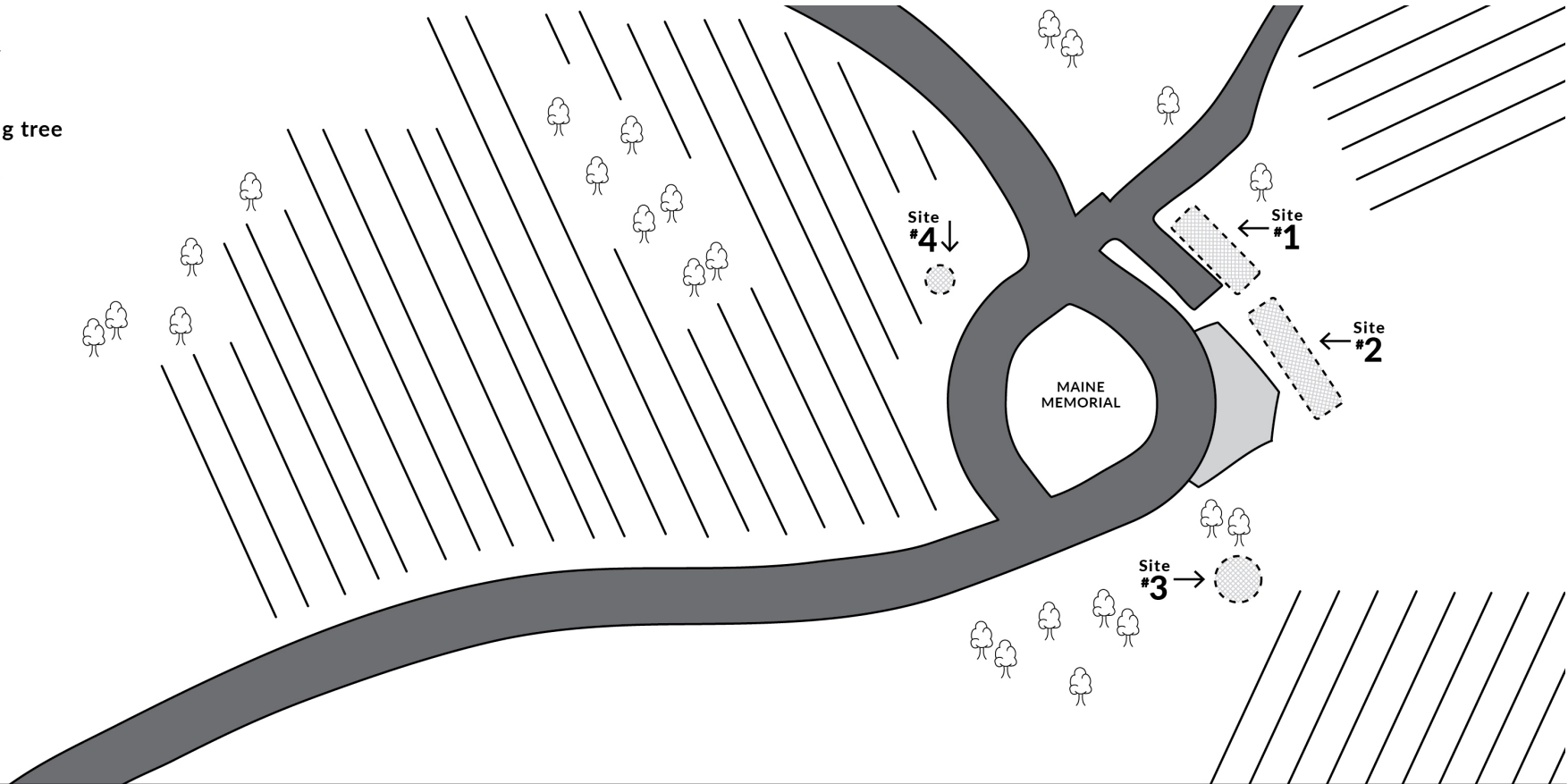

Site #1: Choose 1 shrub

- Sunny site
- Soil drains well

Site #2: Choose 1 shrub

- Partially shaded
- Soil drains well

Site #3: Choose 1 tree

- Partially shaded
- Soil drains well

Site #4: Choose 1 tree

- Sunny area
- Soil drains well

WILDLIFE:

- Fox and small mammals visit wooded areas nearby.
- Birds and insects are the wildlife found most often by the memorial.



BLACK HAW VIBURNUM



White spring flowers, summer berries, and red fall leaves.

- **Size:** Large shrub
- Deciduous
- **Wildlife:** Attracts bees, flies, moths, birds and mammals.
- **Habitat:** Doesn't grow well in shade.

SMOOTH HYDRANGEA



4-inch clusters of large white flowers in summer and yellow leaves in the fall.

- **Size:** Small shrub
- Deciduous
- **Wildlife:** Attracts bees and wasps.
- **Habitat:** Grows well with afternoon shade.

VIRGINIA SWEETSPIRE



5-inch white flower spikes bloom in spring and leaves turn maroon in fall.

- **Height:** Small shrub
- Deciduous
- **Wildlife:** Attracts bees, butterflies, wasps, and birds.
- **Habitat:** Sun or shade near streams.

BOXWOOD

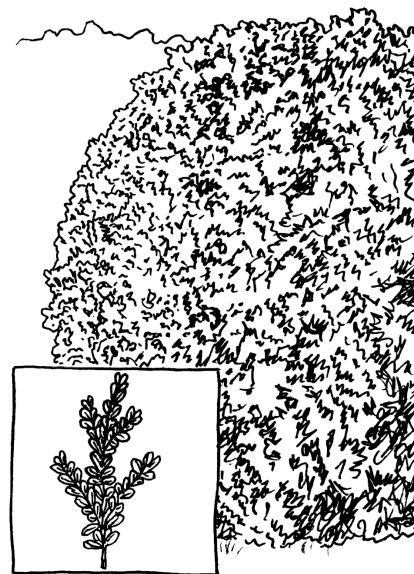

Provides year-round color and works well in more formal landscapes.

- **Height:** Small to large shrub
- Evergreen
- **Wildlife:** Birds may use for winter cover.
- **Habitat:** Does well in many habitats



INKBERRY



Evergreen with white flowers and small black berries.

- **Height:** Medium shrub
- Evergreen
- **Wildlife:** Attracts bees, birds, and small mammals.
- **Habitat:** Grows well in moist soil and sunshine.

MOUNTAIN LAUREL



Clusters of white or pink flowers bloom in the summer.

- **Height:** Large shrub
- Evergreen
- **Wildlife:** Attracts bees, birds and mammals.
- **Habitat:** Grows well in shade.

YELLOW POPLAR (TULIP) TREE



Produces yellowish-green flowers in the spring with yellow leaves in the fall.

- **Height:** Very large tree
- Deciduous
- **Wildlife:** Feeds deer, birds, bees and squirrels.
- **Habitat:** Sunny sites near streams.
- Lives up to 300 years

PIN OAK

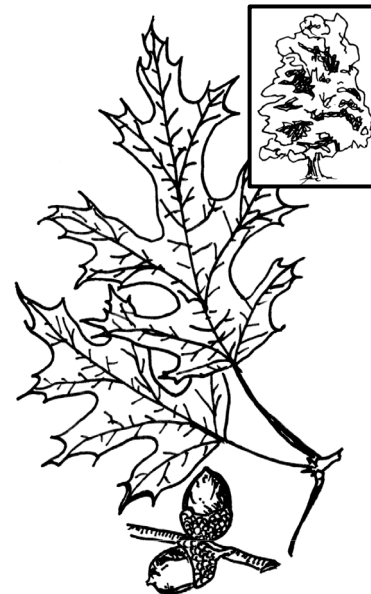

Leaves turn bright shades of red in the fall.

- **Height:** Large tree
- Deciduous
- **Wildlife:** Acorns eaten by birds and squirrels.
- **Habitat:** Grows in wet areas
- Lives up to 120 years



EASTERN REDBUD



Covered in pink blossoms in early spring and yellow leaves in the fall.

- **Height:** Small tree
- Deciduous
- **Wildlife:** Attracts birds and native bees.
- **Habitat:** Grows in sun or shade.
- Lives about 20 years

EASTERN HEMLOCK

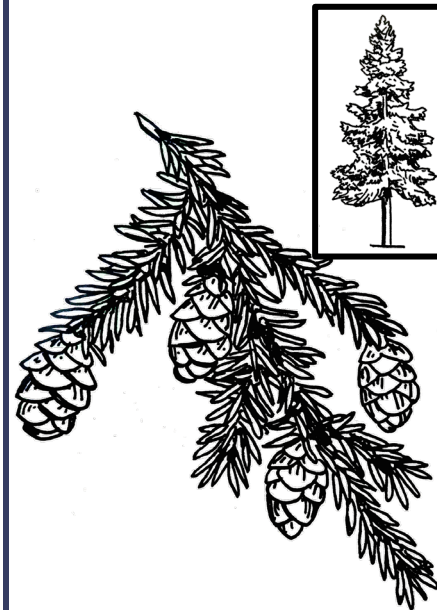

An evergreen tree with small fragrant needles.

- **Height:** Large tree
- Coniferous
- **Wildlife:** Use hemlock trees for shelter.
- **Habitat:** Grows near streams and on cool mountain slopes.
- **Lifespan:** up to 800 years

FLOWERING DOGWOOD



The state tree of Virginia produces attractive white spring flowers with red or purple leaves in the fall.

- **Height:** Small tree
- Deciduous
- **Wildlife:** Birds, deer and rabbits eat the fruit and leaves.
- **Habitat:** Grows in a variety of soils in sun or shade.
- Lives about 80 years

AMERICAN BEECH



Smooth, light gray bark and bright yellow leaves in fall.

- **Height:** Large tree
- Deciduous
- **Wildlife:** Nuts are eaten by many birds and mammals.
- **Habitat:** Grows in many conditions.
- Lives 200-300 years

Name: _____

Class Period: _____

THE PLANT PLAN

Cemetery Section:

What are the biotic and abiotic factors in your section or at your sites?

| Abiotic Factors | Biotic Factors |
|-----------------|----------------|
| | |

Plant Selection:

| Site #1 | Site #2 |
|--|--|
| Plant: Why we chose this plant: | Plant: Why we chose this plant: |
| Site #3 | Site #4 |
| Plant: Why we chose this plant: | Plant: Why we chose this plant: |

